

RAILQ™ RUNWAY SURVEY

Industry-leading rail analysis





Fast, safe, accurate crane rail survey

The condition of the runway influences how well a crane moves on its rails and affects the usability and lifetime of the crane and its travelling machineries. A runway in poor condition leads to reduced crane performance and reliability, and possibly to safety risks.

Konecranes RailQ™ Runway Survey is an industry-leading rail analysis that delivers accurate alignment information of your crane rail and expert recommendations on needed corrective actions.

RailQ takes you beyond guesswork with a proven, accurate and reliable system to help you find answers and make decisions.

BENEFITS

- Requires less time than a traditional survey
- Provides accurate information on the condition and alignment of the runway through systematic application of technology by trained specialists
- Is safer to perform than a traditional runway survey, because it uses a remotely-operated robot

Accurate measurements with less downtime

RailQ uses a remotely-operated robot combined with a visual inspection to provide you with information on runway span, straightness, elevation and rail-to-rail elevation.

The survey data is accurate and repeatable. Our proprietary analysis and visualization software produces reports that visualize the problem areas. Konecranes engineers review all collected data and provide recommendations for corrective actions.

Get a complete view of crane and rail geometry

Konecranes RailQ Runway Survey and CraneQ Crane Geometric Survey work together for a complete view of crane and rail geometry.

The CraneQ Crane Geometric Survey provides accurate information detailing the alignment and the square of a crane. The scope of the survey includes wheels, guide rollers, end trucks, girders, and other components of the crane.

RAILQ DELIVERS EASILY INTERPRETED RESULTS

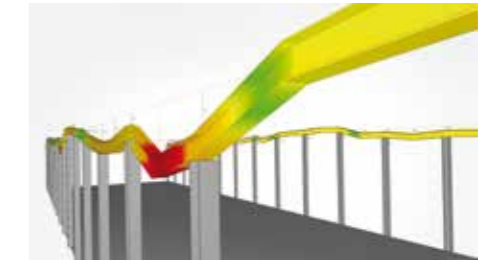

3D visualization of the condition of the rail.

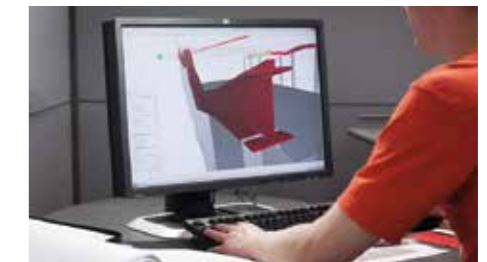

Problem areas are easily communicated.



Recommendations with on-site consultation.

RailQ reports on yourKONECRANES.com

Your RailQ report and recommendations are made available on the yourKONECRANES customer portal. The portal gives you quick and easy access to your crane maintenance information, asset condition and usage data, and agreement details. You get a transparent view of all maintenance activities, TRUCONNECT alerts if applicable, and even spend over any selected time interval. Aggregated data can be viewed, analyzed and shared quickly, for a single asset or an entire fleet.

The portal provides the information you need to help make informed maintenance decisions. During a service visit, our mobile-enabled technicians can quickly and efficiently input information so you have quick access to your service data including findings and recommendations.

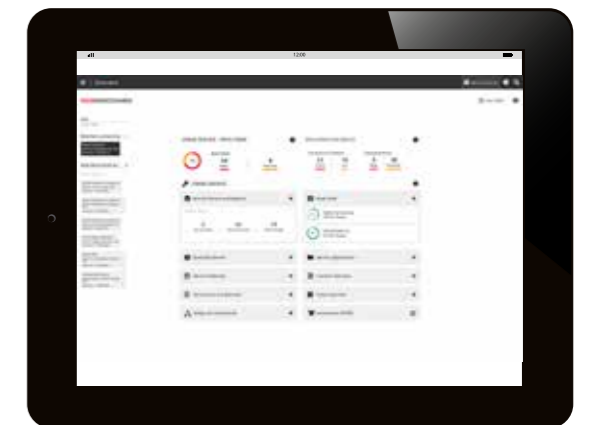

Konecranes is a world-leading group of Lifting Businesses™, serving a broad range of customers, including manufacturing and process industries, shipyards, ports and terminals. Konecranes provides productivity enhancing lifting solutions as well as services for lifting equipment of all makes. In 2019, Group sales totaled EUR 3.33 billion. Including MHE-Demag, the Group has around 18,000 employees in 50 countries. Konecranes shares are listed on the Nasdaq Helsinki (symbol: KCR).

© 2021 Konecranes. All rights reserved. 'Konecranes', 'Lifting Businesses' and  are either registered trademarks or trademarks of Konecranes.

This publication is for general informational purposes only. Konecranes reserves the right at any time, without notice, to alter or discontinue the products and/or specifications referenced herein. This publication creates no warranty on the part of Konecranes, express or implied, including but not limited to any implied warranty or merchantability or fitness for a particular purpose.



Contact us to schedule a RailQ
konecranes.com/contact-us